

Grooved End Swing Check Valve

Swing Check Valve prevents backflow of the medium. The disc opens automatically if the medium flows in the direction indicated by the arrow on the valve body. Gravity assisted closure of the disc occurs when the flow stops or reverses.



Design Features:

- ✦ Grooved End Swing Check Valves are compact check valves with end connection compliant with AWWA C606 standard.
- ✦ Connection compatible with Victaulic joints.
- ✦ High strength ductile iron body used for lowering the weight and improving long term durability.
- ✦ All iron parts are coated inside & outside with fusion bonded epoxy for corrosion resistance per AWWA C550.
- ✦ Bronze Seat Ring reduces wear and tear.
- ✦ Plug on the body for bypass, draining and cleaning.
- ✦ Check valve conforms to the requirements of UL 312 & FM class 1210.
- ✦ NSF61 approved material available as option.

Typical Applications:

General Water Supply, Fire Fighting, HVAC, District Cooling & Sewage System

Technical Data:

Design Standard:	AWWA C606
Size Range:	2" – 12"
Pressure Rating:	350 psi
Working Temperature:	-10°C~+80°C (14°F~176°F)
End Connection:	AWWA C606

Grooved End Swing Check Valves

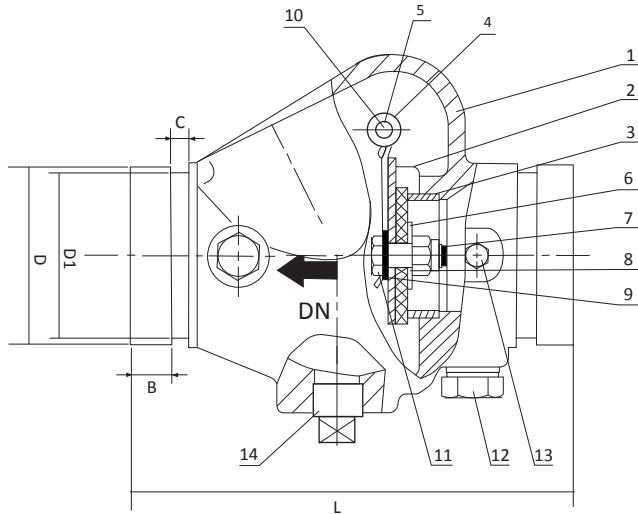

Parts List & Materials

No.	Parts Name	Materials	Standards
1	Body	Ductile Iron	ASTM A536 65-45-12
2	Disc	Stainless Steel	ASTM A276
3	Seat	Al-Bronze	ASTM B148 C95400
4	Spring	Stainless Steel	ASTM A276
5	Hinge Pin	Stainless Steel	SS304
6	Clamping Ring	Stainless Steel	ASTM A276
7	Lock Nut	Stainless Steel	ASTM A276
8	Facing Seal	EPDM	ASTM D2000
9	Gasket	EPDM	ASTM D2000
10	Bolt	Carbon Steel	ASTM A29
11	Bolt	Stainless Steel	ASTM A276
12	Plug	Carbon Steel	ASTM A29
13	Plug	Carbon Steel	ASTM A29
14	Plug	Carbon Steel	ASTM A29

Main Dimensions

unit: mm

Size	DN	L	D*	D1*	B	C
2"	50	169	60.3	57.15	15.88	7.95
2 ½"	65	181	73	69.09	15.88	7.95
3"	80	198	88.9	84.94	15.88	7.95
4"	100	214	114.3	110.08	15.88	9.53
5"	125	248	139.7	135.48	15.88	9.53
6"	150	270	165.1	160.78	15.88	9.53
8"	200	325	216.3	211.6	19.05	11.13
10"	250	457	273	268.3	19.05	12.7
12"	300	535	323.9	318.1	19.05	12.7

*Other diameters available as options, contact us for more details.

PRODUCT SELECTION

VT - XX - SCV-G - X - X - XX - X - XX

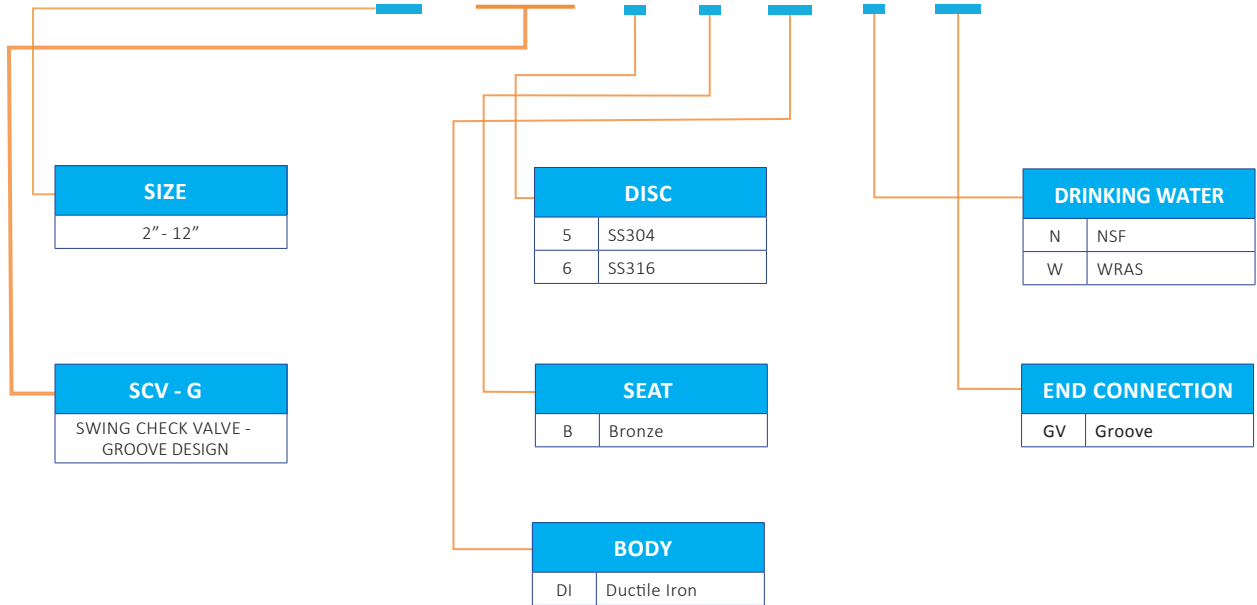

VAHN-TECH International Inc.
 10-755 Queensway East, Mississauga, Ontario L4Y 4C5, Canada
 Tel.: +1 416 342 0001 E-mail: info@vahn-tech.com

www.vahn-tech.com