

FORGED STEEL GATE VALVES

Design

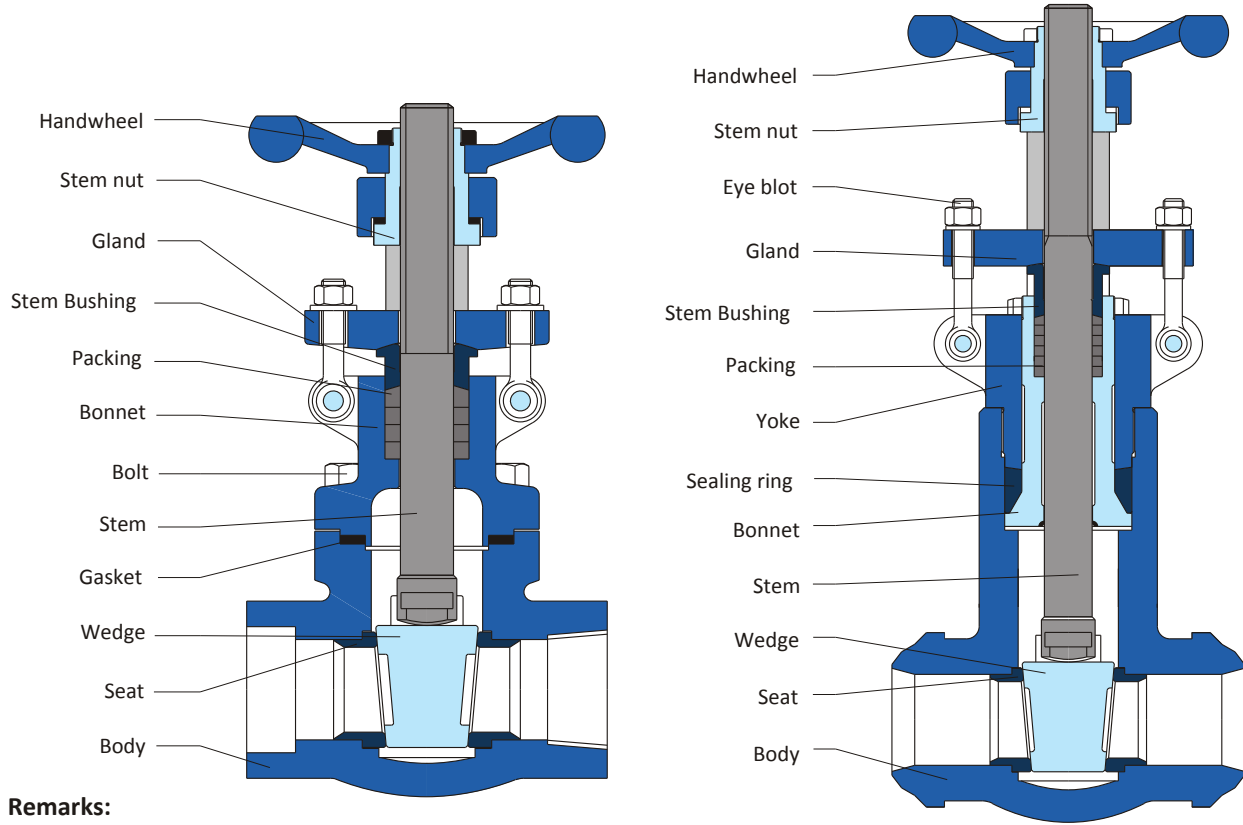

Remarks:

1. Type of end connection referred to Appendix
2. Type of body and bonnet connection referred to Appendix

Main Parts & Materials

No.	Parts Name	Material			
		Carbon Steel		Stainless Steel	Alloy Steel
1	Body	ASTM A105	ASTM A350 LF2/LF3	ASTM A182 F304	ASTM A182 F11/F22
2	Seat	ASTM A182 F6a	ASTM A182 F6a	ASTM A182 F304	ASTM A182 F11/F22
3	Wedge	ASTM A182 F6a	ASTM A182 F6a	ASTM A182 F304	ASTM A182 F6a
4	Stem	ASTM A276-410	ASTM A276-410	ASTM A276-304	ASTM A276-410
5	Gasket	SS304 + Graphite			
6	Sealing Ring	Graphite			
7	Yoke	ASTM A216 WCB	ASTM A216 WCB	ASTM A351 CF8	ASTM A216 WCB
8	Bonnet	ASTM A105	ASTM A350 LF2/LF3	ASTM A182 F304	ASTM A182 F11/F22
9	Bolt	ASTM A193 B7	ASTM A320 L7	ASTM A193 B8	ASTM A193 B16
10	Packing	Graphite			
11	Stem Bushing	ASTM A276-410	ASTM A276-410	ASTM A276-304	ASTM A276-410
12	Gland	ASTM A216 WCB	ASTM A216 WCB	ASTM A351 CF8	ASTM A216 WCB
13	Eyebolt	ASTM A193 B7	ASTM A320 L7	ASTM A193 B8	ASTM A193 B7
14	Stem Nut	ASTM A276-410			
15	Handwheel	ASTM A197 or A47-32510			

FORGED STEEL GATE VALVES

Product Line

Connection Ends	Port	Structure	Pressure		Size									
			PN	Class	8	10	15	20	25	32	40	50	65	
					1/4	3/8	1/2	3/4	1	1 1/4	1 1/2	2	2 1/2	
Flange, Butt weld	RP	BB / WB - OS&Y	1.6 ~ 10.0	150			*	*	*	*	*	*	*	*
				300			*	*	*	*	*	*	*	*
				600			*	*	*	*	*	*	*	*
Flange, Butt weld	FP	BB / WB / PB - OS&Y	1.6 ~ 26.0	900			*	*	*	*	*	*	*	
				1500			*	*	*	*	*	*	*	
Flange, Butt weld	RP	WB / PB - OS&Y	1.6 ~ 42.0	900			*	*	*	*	*	*	*	
				1500			*	*	*	*	*	*	*	
				2500			*	*	*	*	*	*	*	
Threaded, Socket	RP	BB / WB - OS&Y / ISRS	1.6 ~ 10.0	150	*	*	*	*	*	*	*	*	*	
				300	*	*	*	*	*	*	*	*		
				600	*	*	*	*	*	*	*	*		
				800	*	*	*	*	*	*	*	*		
Threaded, Socket	FP	BB / WB - OS&Y / ISRS	1.6 ~ 10.0	150	*	*	*	*	*	*	*	*	*	
				300	*	*	*	*	*	*	*	*		
				600	*	*	*	*	*	*	*	*		
				800	*	*	*	*	*	*	*	*		
Threaded, Socket	FP	BB / WB - OS&Y	1.6 ~ 26.0	900	*	*	*	*	*	*	*	*		
				1500	*	*	*	*	*	*	*	*		
Flange, Butt weld Threaded, Socket	FP	BB / LB - OS&Y	1.6 ~ 10.0	150			*	*	*	*	*	*	*	
				300			*	*	*	*	*	*	*	
				600			*	*	*	*	*	*	*	
				800			*	*	*	*	*	*	*	
Butt weld, Threaded, Socket Threaded, Socket	RP	BB / LB - OS&Y	-	800			*	*	*	*	*	*	*	
				1500			*	*	*	*	*	*	*	

Technical Specification

		Class							PN							
		150	300	600	800	900	1500	2500	1.6	2.5	4.0	6.4	10.0	16	26.0	42.0
Test Pressure (mpa)	Shell Test	2.93	7.55	10.0	20.1	15.0	37.5	63.0	2.4	3.75	6.0	9.6	15.0	24.0	39.0	63.0
	Seal Test (High Pressure)	2.07	5.52	7.31	14.7	11.03	27.5	16.2	1.76	2.75	4.4	7.04	11.0	17.6	28.6	46.2
	Seal Test (Low Pressure)	0.6														
Applicable Temperature		< 425°C														
Medium		Water, Oil & Gas														

FORGED STEEL GATE VALVES

Standard Specification

Design Standard	ASME B16.34 / API 600
Face to Face	ASME B16.10
Flange Ends	ASME B16.5
Butt weld Ends	ASME B16.25
Pressure-Temperature Rating	ASME B16.34
Inspection & Test	API 598

Structure Description

- ✦ Bolted Bonnet or Welded Bonnet
- ✦ Reduced Port
- ✦ Solid Wedge Gate
- ✦ Flange Ends or Butt-welding Ends

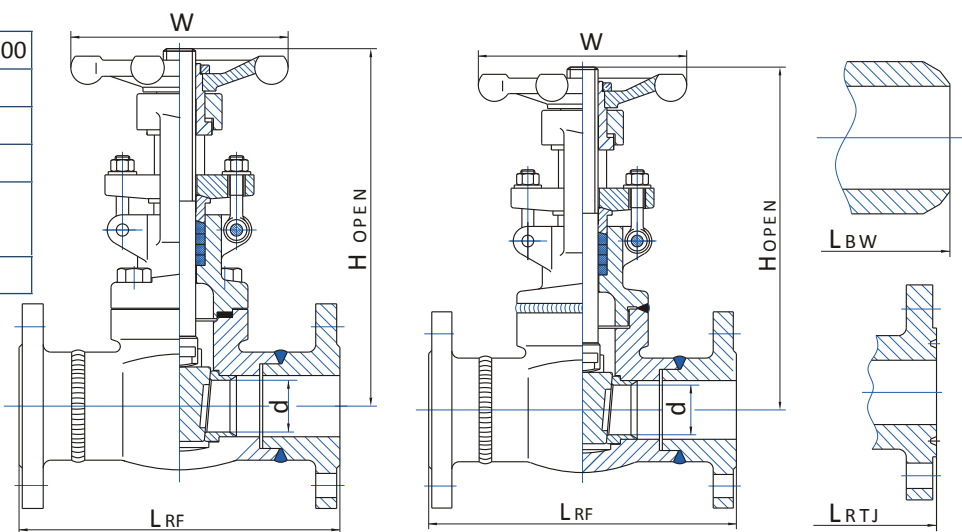

Fig. FGVRFB0

Fig. FGVRFW0

Class 150

Size		Main Dimension						Weight (kg)
Inch	mm	RB	LRF	LBW	LRTJ	H	W	
1/2"	15	10	108	108	119	162	100	3.0
3/4"	20	12.7	117	117	130	162	100	3.5
1"	25	19.1	127	127	140	211	125	5.5
1 1/4"	32	24	140	140	153	238	125	6.8
1 1/2"	40	31.8	165	165	178	257	160	10.4
2"	50	38.1	178	216	190	282	180	14.4
2 1/2"	65	48.5	190	241	203	357	200	24.5

Class 300

Size		Main Dimension						Weight (kg)
Inch	mm	RB	LRF	LBW	LRTJ	H	W	
1/2"	15	10	140	140	151	162	100	3.6
3/4"	20	12.7	152	152	165	162	100	4.9
1"	25	19.1	165	165	178	211	125	7
1 1/4"	32	24	178	178	191	238	125	9.4
1 1/2"	40	31.8	190	190	203	257	160	13.3
2"	50	38.1	216	216	232	282	180	18.0
2 1/2"	65	48.5	241	241	257	357	200	26.2

Class 600

Size		Main Dimension						Weight (kg)
Inch	mm	RB	LRF	LBW	LRTJ	H	W	
1/2"	15	10	165	165	165	162	100	4.2
3/4"	20	12.7	190	190	190	162	100	5.8
1"	25	19.1	216	216	216	211	125	8.8
1 1/4"	32	24	229	229	229	238	125	12.1
1 1/2"	40	31.8	241	241	241	257	160	15.6
2"	50	38.1	292	292	295	282	180	19.5
2 1/2"	65	48.5	330	330	333	357	200	32.0

FORGED STEEL GATE VALVES

Standard Specification

Design Standard	GB/T12234, GB/T12224
Face to Face	GB/T12221, JB/T97-95
Flange Ends	GB/T9113, JB/T82.1~82.4
Butt weld Ends	GB/T12224
Pressure-Temperature Rating	GB/T12224
Inspection & Test	JB/T9092

Structure Description

- ✦ Bolted Bonnet or Welded Bonnet
- ✦ Reduced Port
- ✦ Solid Wedge Gate
- ✦ Flange Ends or Butt-welding Ends

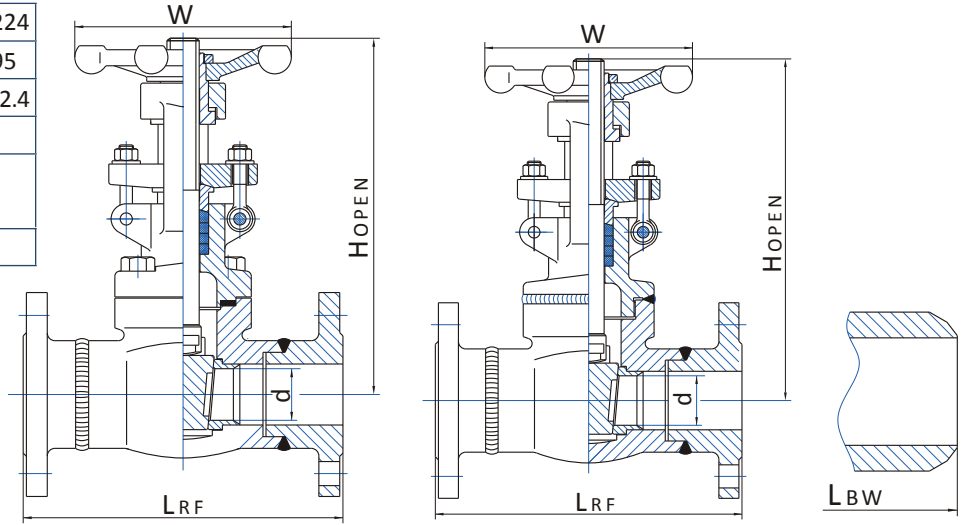

Fig. FGVRFB0

Fig. FGVRFW0

PN1.6 / 2.5

Size		Main Dimension					Weight (kg)
Inch	mm	RB	LRF	LBW	H	W	
1/2"	15	10	130	130	62	100	2.8 / 3.0
3/4"	20	12.7	150	150	162	100	3.2 / 3.5
1"	25	19.1	160	160	211	125	4.9 / 5.5
1 1/4"	32	24	180	180	238	125	5.6 / 6.8
1 1/2"	40	31.8	200	200	257	160	9.8 / 10.4
2"	50	38.1	250	250	282	180	12.8 / 14.4
2 1/2"	65	50.8	265	265	357	200	23.0 / 24.5

PN4.0

Size		Main Dimension					Weight (kg)
Inch	mm	RB	LRF	LBW	H	W	
1/2"	15	10	130	130	162	100	3.6
3/4"	20	12.7	150	150	162	100	4.9 / 5.5
1"	25	19.1	160	160	211	125	7.0
1 1/4"	32	24	180	180	238	125	9.4
1 1/2"	40	31.8	200	200	257	160	13.3
2"	50	38.1	250	250	282	180	18.0
2 1/2"	65	50.8	280	280	357	200	26.2

PN6.4

Size		Main Dimension					Weight (kg)
Inch	mm	RB	LRF	LBW	H	W	
1/2"	15	10	170	170	162	100	3.8
3/4"	20	12.7	190	190	162	100	5.3
1"	25	19.1	210	210	211	125	7.9
1 1/4"	32	24	230	230	238	125	10.5
1 1/2"	40	31.8	250	250	257	160	13.8
2"	50	38.1	250	250	282	180	18.6
2 1/2"	65	50.8	280	280	357	200	27.7

PN10.0

Size		Main Dimension					Weight (kg)
Inch	mm	RB	LRF	LBW	H	W	
1/2"	15	10	170	170	162	100	4.2
3/4"	20	12.7	190	190	162	100	5.8
1"	25	19.1	210	210	211	125	8.8
1 1/4"	32	24	230	230	238	125	12.1
1 1/2"	40	31.8	250	250	257	160	15.6
2"	50	38.1	250	250	282	180	19.5
2 1/2"	65	50.8	280	280	357	200	32.0

FORGED STEEL GATE VALVES

Standard Specification

	GB / JB	ASME / API
Design Standard	GB/T12224, GB/T12224	ASME B16.34 / API 600
Face to Face	GB/T12221, JB/T97-95	ASME B16.10
Flange Ends	GB/T9113, JB/T82.1~82.4	ASME B16.5
Butt weld Ends	GB/T12224	ASME B16.25
Pressure-Temperature Rating	GB/T12224	ASME B16.34
Inspection & Test	JB/T9092	API 598

Structure Description

- ✦ Bolted Bonnet or Welded Bonnet or Pressure Sealed Bonnet
- ✦ Full Port
- ✦ Solid Wedge Gate
- ✦ Flange Ends or Butt-welding Ends

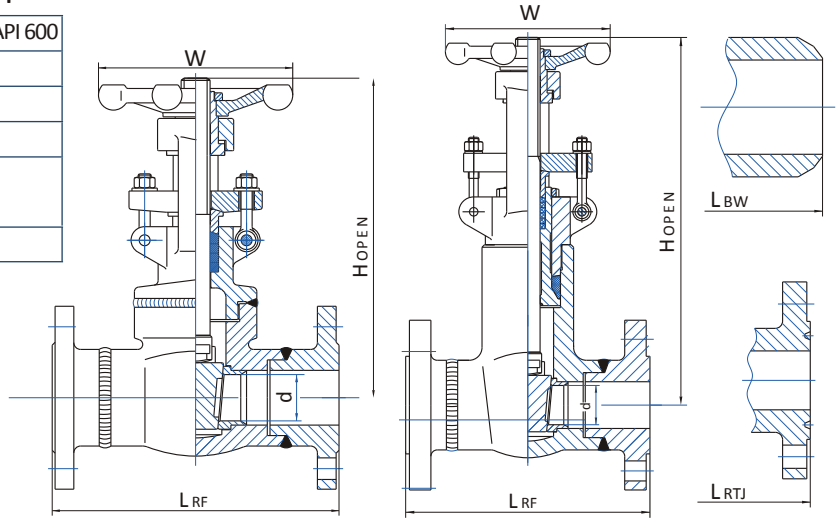

Fig. FGVRFB0

Fig. FGVRFW0

Class 900 / Class 1500

Size		Main Dimension						Weight (kg)		
Inch	mm	FB	LRF	LBW	LRTJ	H		W	BB/WB	PB
						BB/WB	PB			
1/2"	15	13	216	216	216	197	321	125	7.2	17.0
3/4"	20	18	229	229	229	211	321	125	11.5	16.7
1"	25	24	254	254	254	238	321	160	15.6	21.3
1 1/4"	32	29	279	279	279	257	380	160	16.2	24.5
1 1/2"	40	36.5	305	305	305	276	414	180	22.6	28.7
2"	50	46.5	368	368	371	320	502	240	28.2	45.8

PN16.0

Size		Main Dimension						Weight (kg)		
Inch	mm	FB	LRF	LBW	LRTJ	H		W	BB/WB	PB
						BB/WB	PB			
1/2"	15	13	170	170	/	197	321	125	5.2	15.0
3/4"	20	18	190	190	/	211	321	125	11.0	16.0
1"	25	24	210	210	/	238	321	160	15.3	21.0
1 1/4"	32	29	230	230	/	257	380	160	14.8	23.0
1 1/2"	40	36.5	260	260	/	276	414	180	20.3	26.4
2"	50	46.5	300	300	/	320	502	240	27.5	45.0

PN26.0

Size		Main Dimension						Weight (kg)		
Inch	mm	FB	LRF	LBW	LRTJ	H		W	BB/WB	PB
						BB/WB	PB			
1/2"	15	13	216	216	/	197	321	125	7.2	17.0
3/4"	20	18	229	229	/	211	321	125	11.5	16.7
1"	25	24	254	254	/	238	321	160	15.6	21.3
1 1/4"	32	29	279	279	/	257	380	160	16.2	424.5
1 1/2"	40	36.5	305	305	/	276	414	180	22.6	28.7
2"	50	46.5	368	368	/	320	502	240	28.2	45.8

FORGED STEEL GATE VALVES

Standard Specification

	GB / JB	ASME / API
Design Standard	GB/T12224, GB/T12224	ASME B16.34 / API 600
Face to Face	GB/T12221, JB/T97-95	ASME B16.10
Flange Ends	GB/T9113, JB/T82.1~82.4	ASME B16.5
Butt weld Ends	GB/T12224	ASME B16.25
Pressure-Temperature Rating	GB/T12224	ASME B16.34
Inspection & Test	JB/T9092	API 598

Structure Description

- ✦ Bolted Bonnet or Welded Bonnet or Pressure Sealed Bonnet
- ✦ Full Port
- ✦ Solid Wedge Gate
- ✦ Flange Ends or Butt-welding Ends

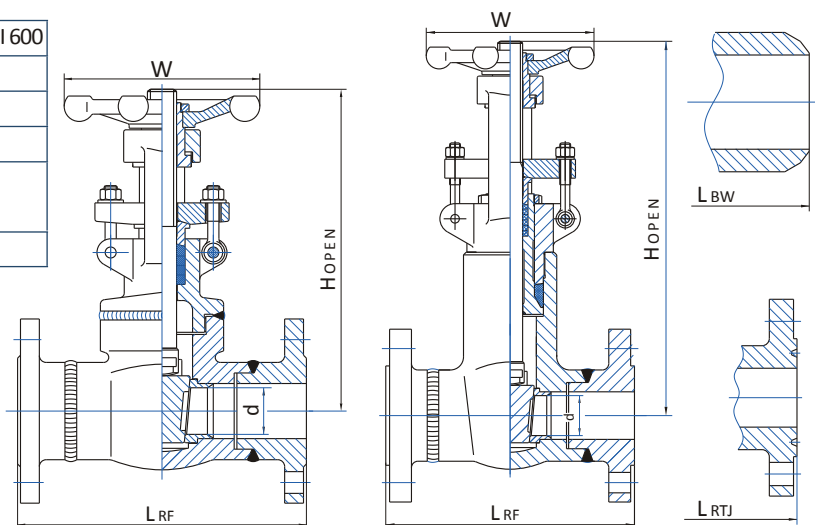

Fig. FGVRFB0

Fig. FGVRFW0

Class 900 / PN16.0

Size		Main Dimension						Weight (kg)		
Inch	mm	FB	LRF	LBW	LRTJ	H		W	BB/WB	PB
						BB/WB	PB			
1/2"	15	10	216	216	216	197	321	180	9.8	11.5
3/4"	20	13	229	229	229	211	321	180	9.7	11.2
1"	25	19	254	254	254	238	321	180	9.5	10.8
1 1/4"	32	24	279	279	279	257	380	200	17.5	18.0
1 1/2"	40	40	305	305	305	276	414	200	21.6	22.0
2"	50	50	368	368	371	320	502	300	42.7	44.0

Class 1500 / PN26.0

Size		Main Dimension						Weight (kg)		
Inch	mm	FB	LRF	LBW	LRTJ	H		W	BB/WB	PB
						BB/WB	PB			
1/2"	15	10	216	216	216	197	321	180	9.8	11.5
3/4"	20	13	229	229	229	211	321	180	9.7	11.2
1"	25	19	254	254	254	238	321	180	9.5	10.8
1 1/4"	32	24	279	279	279	257	380	200	17.5	18.0
1 1/2"	40	40	305	305	305	276	414	200	21.6	22.0
2"	50	50	368	368	371	320	502	300	42.7	44.0

Class 2500 / PN42.0

Size		Main Dimension						Weight (kg)		
Inch	mm	FB	LRF	LBW	LRTJ	H		W	BB/WB	PB
						BB/WB	PB			
1/2"	15	10	264	264	264	197	321	180	12.3	13.0
3/4"	20	13	273	273	273	211	321	180	12.1	12.7
1"	25	19	308	308	308	238	321	180	11.8	12.5
1 1/4"	32	24	349	349	352.2	257	380	200	20.9	21.8
1 1/2"	40	40	384	384	378.2	276	414	200	27.5	29.3
2"	50	50	451	451	454.2	320	502	300	53.5	55.4

FORGED STEEL GATE VALVES

Standard Specification

	GB / JB	ASME / API
Design Standard	JB/T7746	API 602
Face to Face	JB/T7746	Factory Standard
Socket-Welded Ends	JB/T1751	ASME B16.11
Threaded Ends	GB/T7306	ASME B1.20.1
Pressure-Temperature Rating	GB/T12224	ASME B16.34
Inspection & Test	JB/T9092	API 598

Structure Description

- ✦ Bolted Bonnet or Welded Bonnet
- ✦ Outside Screw Stem or Inside Screw Stem
- ✦ Full Port or Reduced Port
- ✦ Solid Wedge Gate
- ✦ Threaded Ends or SW Ends

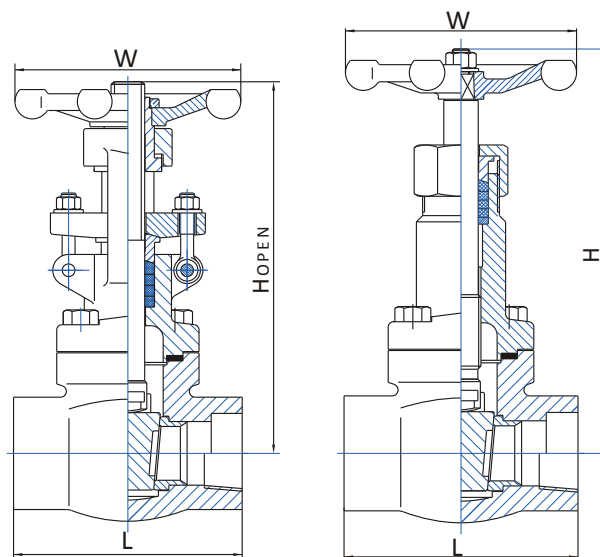

Fig. SW(I)B0

Fig. SW(T)BI

Class 150 - 600 / PN1.6 ~ 10.0

	Structure	Size		Main Dimension			Weight (kg)	
		Inch	mm	d	L	H		W
REDUCED BORE	OS&Y	1/4"	8	7	79	166	100	2.2
		3/8"	10	10	79	166	100	2.2
		1/2"	15	10	79	166	100	2.2
		3/4"	20	13	92	169	100	2.2
		1"	25	18	111	193	125	4.7
		1 1/4"	32	24	120	236	160	5.9
		1 1/2"	40	29	120	146	160	6.9
		2"	50	36.5	140	283	180	11.1

	Structure	Size		Main Dimension			Weight (kg)	
		Inch	mm	d	L	H		W
FULL BORE	OS&Y	1/4"	8	7	79	166	100	2.2
		3/8"	10	10	79	166	100	2.2
		1/2"	15	13	92	169	100	2.2
		3/4"	20	18	111	193	125	4.3
		1"	25	24	120	236	160	5.9
		1 1/4"	32	29	120	146	160	6.9
		1 1/2"	40	36.5	140	283	180	11.1
		2"	50	46.5	178	330	200	15.2

Class 150 - 600 / PN1.6 ~ 10.0

	Structure	Size		Main Dimension			Weight (kg)	
		Inch	mm	d	L	H		W
REDUCED BORE	ISRS	1/4"	8	7	79	169	100	2.2
		3/8"	10	10	79	169	100	2.2
		1/2"	15	10	79	169	100	2.2
		3/4"	20	13	92	182	100	2.2
		1"	25	18	111	208	125	4.6
		1 1/4"	32	24	120	254	160	5.9
		1 1/2"	40	29	120	290	160	6.9
		2"	50	36.5	140	330	180	11.1

	Structure	Size		Main Dimension			Weight (kg)	
		Inch	mm	d	L	H		W
FULL BORE	ISRS	1/4"	8	7	79	169	100	2.4
		3/8"	10	10	79	169	100	2.4
		1/2"	15	13	92	182	100	2.3
		3/4"	20	18	111	208	125	4.8
		1"	25	24	120	254	160	6.1
		1 1/4"	32	29	120	290	160	7.2
		1 1/2"	40	36.5	140	330	180	11.2
		2"	50	46.5	178	372	200	14.1

FORGED STEEL GATE VALVES

Standard Specification

	GB / JB	ASME / API
Design Standard	JB/T7746	API 602
Face to Face	JB/T7746	Factory Standard
Socket-Welded Ends	JB/T1751	ASME B16.11
Threaded Ends	GB/T7306	ASME B1.20.1
Pressure-Temperature Rating	GB/T12224	ASME B16.34
Inspection & Test	JB/T9092	API 598

Structure Description

- ✦ Bolted Bonnet or Welded Bonnet or Pressure Sealed Bonnet
- ✦ Outside Screw Stem or Inside Screw Stem
- ✦ Full Port or Reduced Port
- ✦ Solid Wedge Gate
- ✦ Threaded Ends or SW Ends

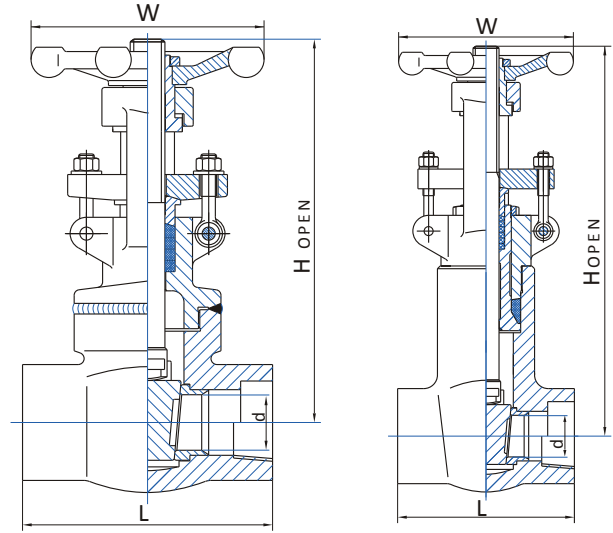

Fig. FGVSW(T)B0

Fig. FGVSW(T)P0

Class 900 / PN16.0

Structure	Size		Main Dimension			Weight (kg)	
	Inch	mm	d	L	H		W
BB WB	1/4"	8	7	10	166	120	3.6
	3/8"	10	10	102	166	120	3.5
	1/2"	15	13	102	169	120	3.4
	3/4"	20	18	111	193	125	3.8
	1"	25	24	120	230	160	7.8
	1 1/4"	32	29	120	246	160	11.9
	1 1/2"	40	36.5	140	283	180	12.2
	2"	50	46.5	178	330	200	21.9

Structure	Size		Main Dimension			Weight (kg)	
	Inch	mm	d	L	H		W
PB	1/2"	15	13	140	321	125	11.5
	3/4"	20	18	140	321	125	11.0
	1"	25	24	140	321	160	10.2
	1 1/4"	32	29	178	380	160	20.5
	1 1/2"	40	36.5	178	414	180	21.7
	2"	50	46.5	216	502	240	43.5

Class 1500 / PN26.0

Structure	Size		Main Dimension			Weight (kg)	
	Inch	mm	d	L	H		W
BB WB	1/4"	8	7	102	166	120	3.6
	3/8"	10	10	102	166	120	3.5
	1/2"	15	13	102	169	120	3.4
	3/4"	20	18	111	193	125	3.8
	1"	25	24	120	230	160	7.8
	1 1/4"	32	29	120	246	160	11.9
	1 1/2"	40	36.5	140	283	180	12.2
	2"	50	46.5	178	330	200	21.9

Structure	Size		Main Dimension			Weight (kg)	
	Inch	mm	d	L	H		W
PB	1/2"	15	13	140	321	125	11.5
	3/4"	20	18	140	321	125	11.0
	1"	25	24	140	321	160	10.2
	1 1/4"	32	29	178	380	160	20.5
	1 1/2"	40	36.5	178	414	180	21.7
	2"	50	46.5	216	502	240	43.5

FORGED STEEL GATE VALVES

Standard Specification

	GB / JB	ASME / API
Design Standard	GB/T12234, JB/T7749	API 602 / API 600
Face to Face	GB/T12221, JB/T7749, JB/T97-95	ASME B16.10
Flange Ends	GB/T9113, JB/T82.1~82.4	ASME B16.5
Butt weld Ends	GB/T12224	ASME B16.25
Socket-welded End	JB/T1751	ASME B16.11
Threaded Ends	GB/T7306	ASME B1.20.1
Pressure-Temperature Rating	GB/T12224	ASME B16.34
Inspection & Test	JB/T9092	API 598

Structure Description

- ✦ Bolted & Lengthened Bonnet (Low Temperature)
- ✦ Full Port
- ✦ Solid Wedge Gate
- ✦ Flange Ends or Butt-welding Ends or Threaded Ends or SW Ends

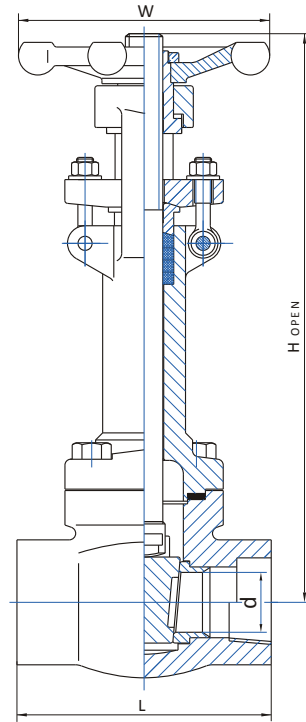

Fig. FGVSW(T)LO

Class 150 / Class 300

R F / M F M	B W	Size		Main Dimension			
		Inch	mm	FB	L	H	W
		1/2"	15	13	140	333	125
		3/4"	20	18	152	360	125
		1"	25	24	165	407	160
		1 1/4"	32	29	178	475	160
		1 1/2"	40	36.5	190	475	180
		2"	50	46.5	216	551	200

S W	G / T	Size		Main Dimension				Weight (kg)
		Inch	mm	FB	L	H	W	
		1/2"	15	13	92	333	125	
		3/4"	20	18	111	360	125	9.4
		1"	25	24	120	407	160	13.5
		1 1/4"	32	29	120	475	160	15.0
		1 1/2"	40	36.5	140	475	180	17.8
		2"	50	46.5	178	551	200	28.0

Class 600

R F / M F M	B W	Size		Main Dimension			
		Inch	mm	FB	L	H	W
		1/2"	15	13	165	333	125
		3/4"	20	18	190	360	125
		1"	25	24	216	407	160
		1 1/4"	32	29	229	475	160
		1 1/2"	40	36.5	241	475	180
		2"	50	46.5	292	551	200

S W	G / T	Size		Main Dimension				Weight (kg)
		Inch	mm	FB	L	H	W	
		1/2"	15	13	92	333	125	
		3/4"	20	18	111	360	125	9.4
		1"	25	24	120	407	160	13.5
		1 1/4"	32	29	120	475	160	15.0
		1 1/2"	40	36.5	140	475	180	17.8
		2"	50	46.5	178	551	200	28.0

FORGED STEEL GATE VALVES

Class 800

R F / M F M	Size		Main Dimension			
	Inch	mm	FB	L	H	W
	B W					
	1/2"	15	13	-	333	125
	3/4"	20	18	-	360	125
	1"	25	24	-	407	160
	1 1/4"	32	29	-	475	160
	1 1/2"	40	36.5	-	475	180
	2"	50	46.5	-	551	200

S W	G / T	Size		Main Dimension				Weight (kg)
		Inch	mm	FB	L	H	W	
		B W						
		1/2"	15	13	92	333	125	7.1
		3/4"	20	18	111	360	125	9.4
		1"	25	24	120	407	160	13.5
		1 1/4"	32	29	120	475	160	15.0
		1 1/2"	40	36.5	140	475	180	17.8
		2"	50	46.5	1078	551	200	28.0

PN1.6 ~ 4.0

R F / M F M	Size		Main Dimension			
	Inch	mm	FB	L	H	W
	B W					
	1/2"	15	13	130	333	125
	3/4"	20	18	150	360	125
	1"	25	24	160	407	160
	1 1/4"	32	29	180	475	160
	1 1/2"	40	36.5	200	475	180
	2"	50	46.5	250	551	200

S W	G / T	Size		Main Dimension				Weight (kg)
		Inch	mm	FB	L	H	W	
		B W						
		1/2"	15	13	92	333	125	7.1
		3/4"	20	18	111	360	125	9.4
		1"	25	24	120	407	160	13.5
		1 1/4"	32	29	120	475	160	15.0
		1 1/2"	40	36.5	140	475	180	17.8
		2"	50	46.5	178	551	200	28.0

PN6.4 ~ 10.0

R F / M F M	Size		Main Dimension			
	Inch	mm	FB	L	H	W
	B W					
	1/2"	15	13	170	333	125
	3/4"	20	18	190	360	125
	1"	25	24	210	407	160
	1 1/4"	32	29	230	475	160
	1 1/2"	40	36.5	250	475	180
	2"	50	46.5	250	551	200

S W	G / T	Size		Main Dimension				Weight (kg)
		Inch	mm	FB	L	H	W	
		B W						
		1/2"	15	13	92	333	125	7.1
		3/4"	20	18	111	360	125	9.4
		1"	25	24	120	407	160	13.5
		1 1/4"	32	29	120	475	160	15.0
		1 1/2"	40	36.5	140	475	180	17.8
		2"	50	46.5	178	551	200	28.0

FORGED STEEL GATE VALVES

Standard Specification

Design Standard	API 602 / API 600
Face to Face	ASME B16.10
Flange Ends	ASME B16.5
Butt weld Ends	ASME B16.25
Socket-welded End	ASME B16.11
Threaded Ends	ASME B1.20.1
Pressure-Temperature Rating	ASME B16.34
Inspection & Test	API 598

Structure Description

- ✦ Bolted & Welded Bonnet
- ✦ Reduced Port
- ✦ Solid Wedge Gate
- ✦ Butt-welding Ends or Threaded Ends or SW Ends

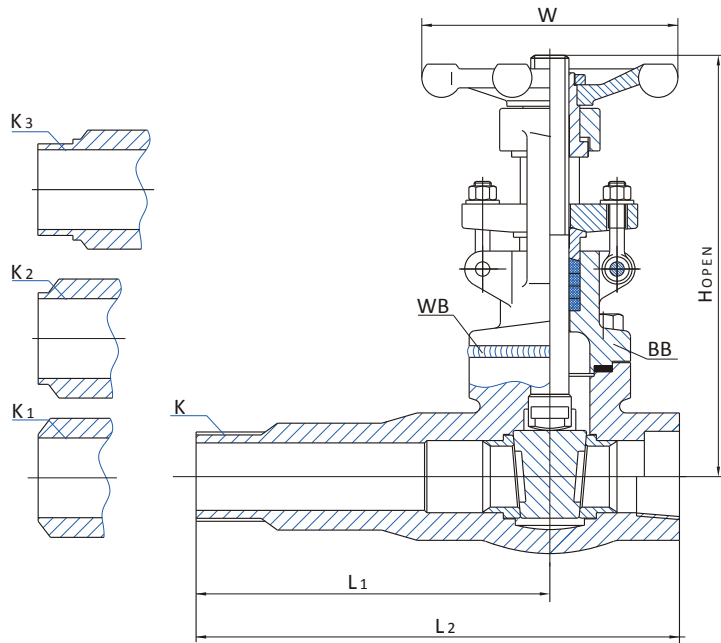

Class 800

Size		Main Dimension										Weight (kg)		
Inch	mm	RB	L1				L				H	W	K2	K/K1/K3
			K	K1	K2	K3	K	K1	K2	K3				
1/2"	15	10	108	-	152	108	153	-	192	153	151	100	2.5	2.2
3/4"	20	13	108	10	150	108	153	153	215	153	158	100	2.7	2.4
1"	25	19	127	127	184	127	182	182	239	182	185	125	4.5	3.4
1 1/4"	32	24	127	127	184	127	182	182	239	182	239	160	4.8	4.1
1 1/2"	40	29	152	152	193	152	216	216	258	216	243	16	8.5	8.0
2"	50	36.5	152	152	197	152	216	216	262	216	279	180	10.5	9.8

Class 1500

Size		Main Dimension										Weight (kg)		
Inch	mm	RB	L1				L				H	W	K2	K/K1/K3
			K	K1	K2	K3	K	K1	K2	K3				
1/2"	15	10	108	-	52	108	153	-	192	153	151	100	2.5	2.2
3/4"	20	13	108	-	150	108	153	-	215	153	158	100	2.7	2.4
1"	25	19	127	-	184	127	182	-	239	182	182	125	4.5	3.4
1 1/4"	32	24	127	-	184	127	182	-	239	182	239	160	4.8	4.1
1 1/2"	40	29	152	-	193	152	216	-	258	216	243	160	8.5	8.0
2"	50	36.5	152	-	197	152	216	-	262	216	273	180	10.5	9.8

HOW TO ORDER

VT - XX - FGV - XX - XX - XX - XX - X - XXX

